

N
NORTH POINT VARIES
REFER TO SITE LAYOUT
PLAN

GROUND FLOOR PLAN C19.2, 19.1 & C20.1

SCALE 1:100

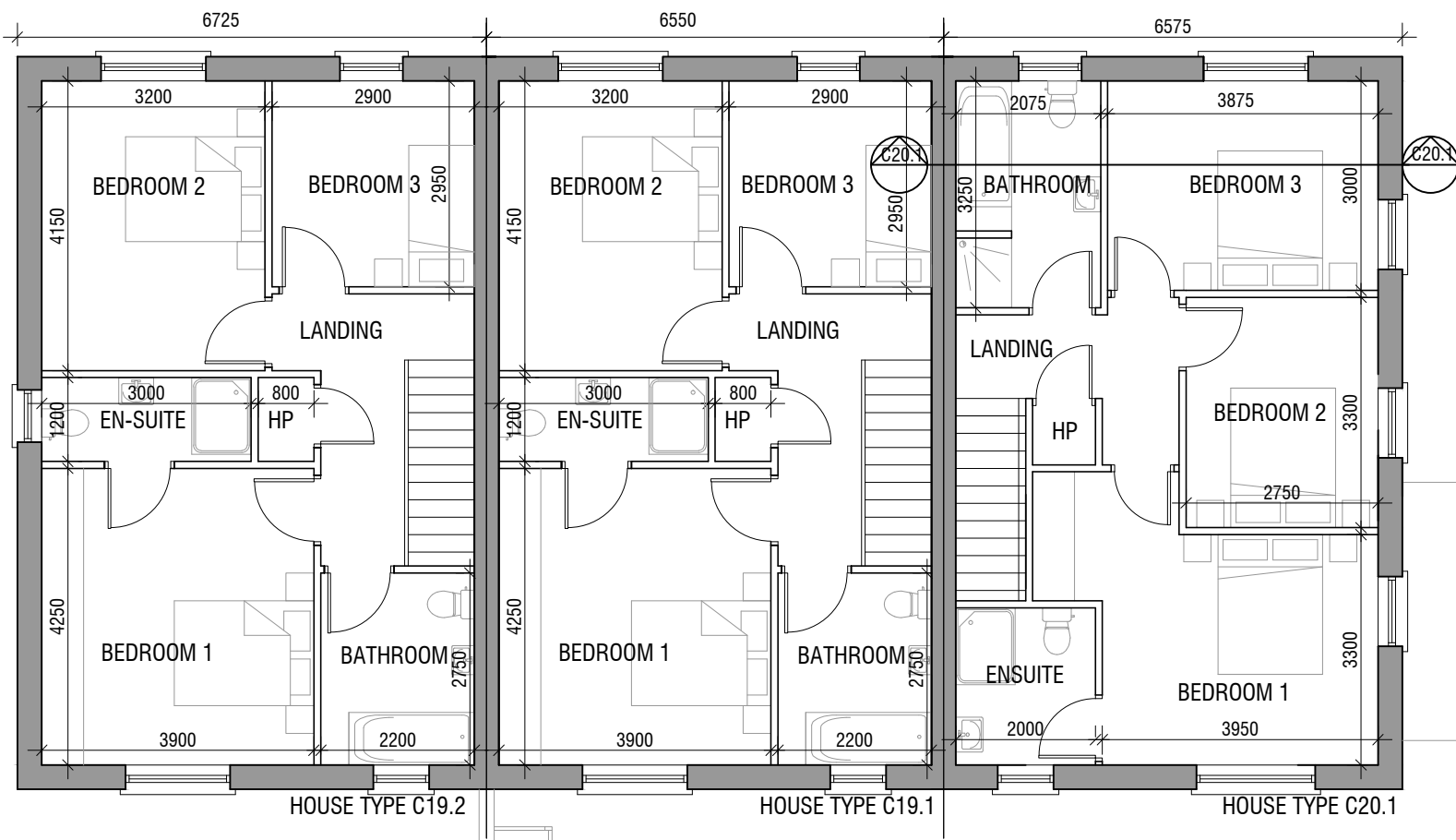

FIRST FLOOR PLAN C19.2, 19.1 & C20.1

SCALE 1:100

HOUSE TYPE C20.1/C19.2/C19.1

TERRACE - 3 BEDROOM HOUSE (CORNER)

	(HOUSE C20.1)	(HOUSE C19.1 & 19.2)
GROUND FLOOR	61.2 m ²	68.9 m ²
FIRST FLOOR	56.4 m ²	57.8 m ²
TOTAL	117.6 m² / 1266 ft²	116.7 m² / 1256 ft²

PROPOSED MATERIALS

ROOF:	SELECTED BLUE / BLACK TILE & FLAT ROOF MEMBRANE
WALLS:	BRICK & PAINTED RENDER
WINDOWS:	GREY OR APPROVED COLOUR
DOORS:	HARDWOOD / PVC TO SELECTED COLOUR

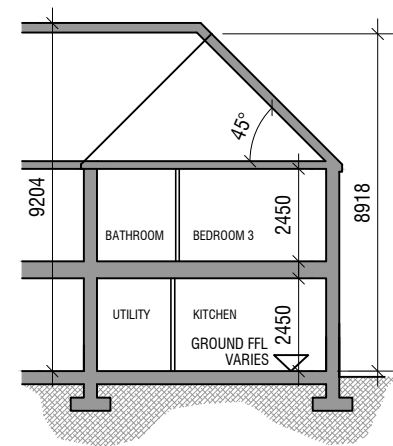

SECTION C20.1

SCALE 1:200